

**SAMPLE ROAD
(STATE ROAD NO. 834)**

GRAPHIC SCALE

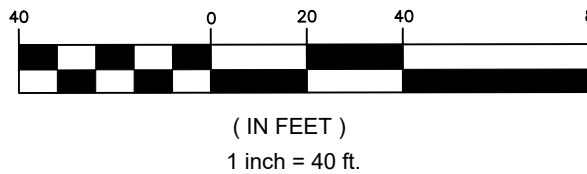

HATCH LEGEND

- PROPOSED CONCRETE SIDEWALK (SEE DETAIL SHEET C-11.0)
- PROPOSED LIMITS OF MILLING AND RESURFACING
- PROPOSED LANDSCAPING
- PROPOSED PAVERS
- PROPOSED NEW PAVEMENT (SEE PAVING DETAILS THIS SHEET)

NW 27TH AVE.

FUTURE RACETRAC
BUILDING
(PERMIT BY OTHERS)

EXISTING
FESTIVAL FLEA MARKET
TO REMAIN
381,762 S.F.
F.F.E.=12.94' N.A.V.D.

12' U.E. VACATED BY O.R.B.
12654, PG. 941,
O.R.B. 12670, PG. 481 &
O.R.B. 12186, PG. 72
TANK

BOLLARD
(TYPICAL)

BOLLARD
(TYPICAL)

55' U.E.
O.R.B. 12627,
PG. 130

(EASMENT "A" O.R.B. 21444, PG. 925)

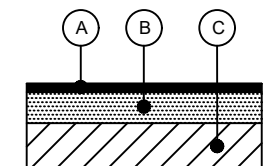

- A 1.5" FLORIDA DOT ASPHALT TYPE S-III, OR S-III-R, PER CITY OF MIAMI GARDENS, ASPHALT SHALL BE PLACED IN TWO (2) LIFTS.
ALTERNATELY, FDOT ROAD AND BRIDGE DESIGN CRITERIA FOR A SUPER PAVE MIXTURE WITH AN EQUIVALENT TRAFFIC LEVEL DESIGN MIXTURE AS ABOVE, WILL BE ACCEPTED.
- B 8" CRUSHED LIMEROCK BASE COURSE HAVING A MINIMUM LBR OF 100 AND MINIMUM CARBON CALCIUM CONTENT 70%
COMPACTED TO AT LEAST 98% OF THE MODIFIED PROCTOR MAXIMUM DRY DENSITY PER ASTM D-1557, PLACED IN (2) LIFTS, PER MG, PW.
- C TYPE B OR C, 12" STABILIZED SUB-BASE FILLED WITH MINIMUM LBR OF 40 COMPACTED TO AT LEAST 98% OF THE MODIFIED PROCTOR MAXIMUM DRY DENSITY PER ASTM D-1557.

**LIGHT AND MEDIUM DUTY
FLEXIBLE PAVEMENT**
N.T.S.

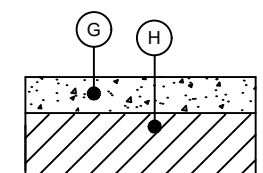

- G 6 INCHES OF REINFORCED CONCRETE, WITH A MINIMUM COMPRESSIVE STRENGTH OF 5000 PSI
- H 12" CRUSHED LIMEROCK BASE COURSE HAVING A MINIMUM LBR OF 100 AND MINIMUM CARBON CALCIUM CONTENT 70%
COMPACTED TO AT LEAST 98% OF THE MODIFIED PROCTOR MAXIMUM DRY DENSITY PER ASTM D-1557, PLACED IN (2) LIFTS, PER MG, PW.
12" LIMEROCK BASE (HEAVYLOAD PAVEMENT) TO BE PLACED IN (2) 6" COMPACTED LIFTS

HEAVY LOADING (USE)
LOADING AREAS, DUMPSTER PADS
N.T.S.

NOTES:
1. BASE MATERIAL SHALL BE EXTENDED A MINIMUM OF 1 FOOT BEYOND THE BACK OF CURB AND SUB-BASE SHALL BE EXTENDED 1 FOOT MIN. BEYOND THE BASE.

NOTE:
SEE GEOTECHNICAL REPORT, (PREPARED BY EAST COAST TESTING AND ENGINEERING DATED JUNE 20, 2016.), FOR SITE PREPARATION AND DETAILED PAVEMENT SECTION REQUIREMENTS.

PAVING DETAILS
N.T.S.